

## Instructions for constructing a paper model Hilux

Difficulty level: ★★★ Construction time (approx.): 1hour

### Step 1 Print out the paper model

---

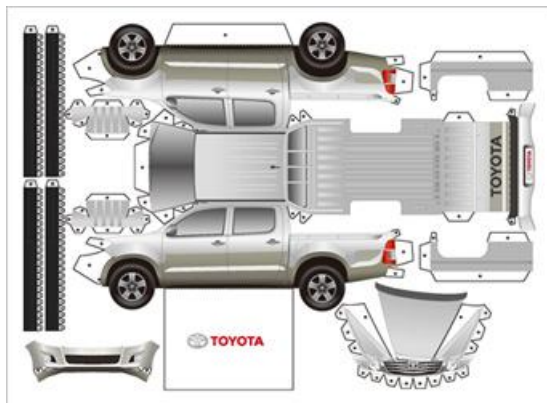

Print out the paper model in landscape orientation on a sheet of paper.

#### Explanation of markings

—	Cutting line	- - - -	Folding line(outward)
- - - -	Folding line (inward)	*	Tab

#### Tip for better results

Print the model on paper that is slightly thicker than regular paper. Using thicker paper will make the model easier to construct, so you will get a better finished product.

### Step 2 Prepare the necessary tools for constructing the paper model

---



Prepare the necessary tools for constructing the paper model. They are:

1. Scissors
2. Craft knife
3. Cutting mat
4. A pointed object such as a ballpoint pen that has run out of ink (use for creating indentations along folding lines)
5. Ruler
6. Cotton swab (cotton bud)
7. Paste or craft glue

#### Tip for better results

Using the tools listed below will help you to make a better paper model:

- Tweezers (used when constructing the detailed areas)
- Paint set, colored pencils, or colored pens (use for coloring in areas where the paper is cut)

### Step 3 Cut out the paper model

---

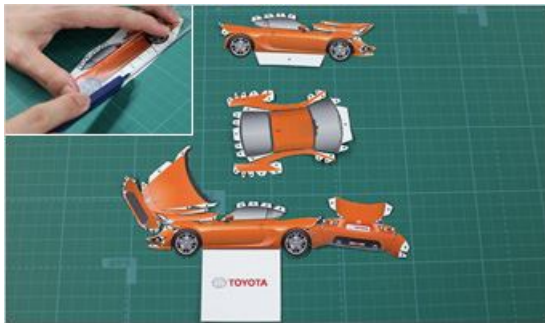
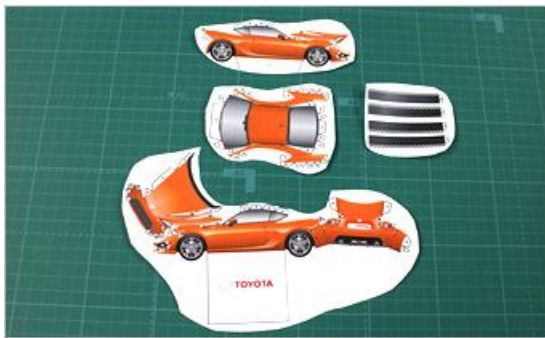

- Use scissors to roughly cut out the various parts of the paper model. Next, using a ruler and craft knife, cut along the cutting lines to remove all excess paper.

#### Check point

- When using scissors or a craft knife, be careful not to cut your finger or hand.
- Ensure the room you are working in is well ventilated.

#### Tip for better results

Before cutting out the various pieces, create indentations along all folding lines by tracing over them with a pointed object. This will make folding easier, helping you to achieve a better finished product.



#### Tip for better results

Improve the model's appearance by painting or coloring over the edges where the paper was cut so that white lines are not visible.

## Step 4 Construct the paper model

Glue to the various parts of the paper model together in the order outlined below.

#### Tip for better results

When applying paste or craft glue to the tabs, use a cotton swab or something similar, and only apply a thin layer. This will make gluing the model together easier.

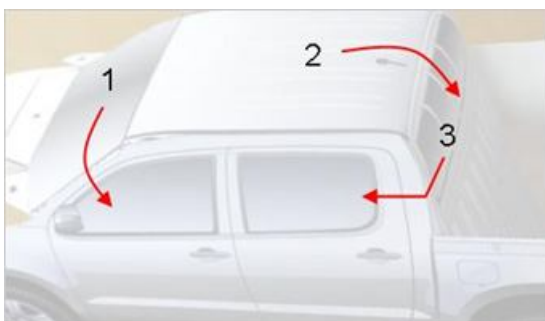

1. Glue the tabs to the side section without folding them (make the paper a rounded shape as you glue it).  
(Repeat the same process on the opposite side.)
2. Make the rear roof section a round shape without creasing the body.
3. Fold the tabs inward and glue them to the side section.  
(Repeat the same process on the opposite side.)

#### Tip for better results

Gently wrapping parts that you wish to make a rounded shape around a cylindrical object such as a pen will help to give them the desired shape.

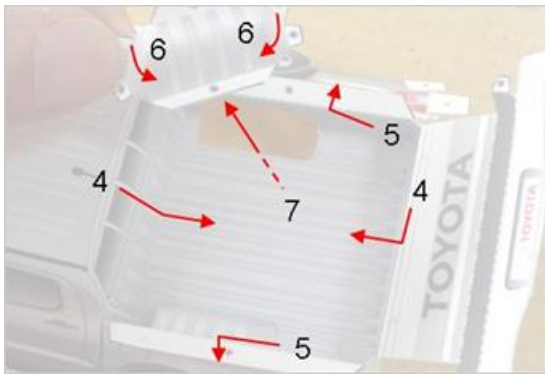

4. Fold the tray outward along the folding lines at both ends.
5. Fold the tab at the top of the side section of the tray inward and glue it to the inside of the side section of the body.  
(Repeat the same process on the opposite side.)
6. Make the wheel cover section a rounded shape and glue it together.
7. Fold the tabs on the wheel cover section outward and glue them to the back side of the tray section.  
(Repeat these processes on the opposite side.)

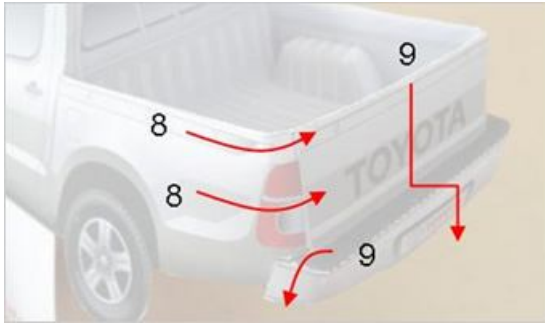

8. Glue the tabs at the rear of the side section to the rear section of body without folding them (make the paper a rounded shape as you glue it).  
(Repeat the same process on the opposite side.)
9. Fold the rear section of the tray inward along the upper folding line, outward along the middle folding line, and inward along bottom folding line, then glue the ends of the bumper to the tabs without creasing them (make the paper a rounded shape as you glue it).

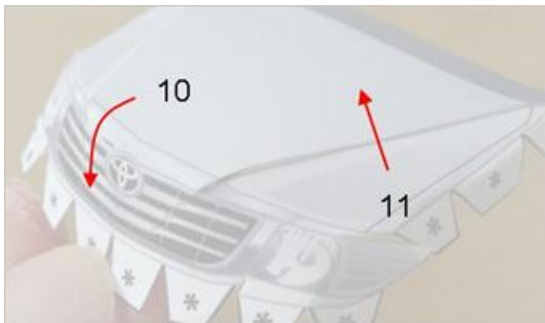

10. Glue the tab to the hood section without creasing it (make the paper a rounded shape as you glue it).
11. Glue the tabs to the underside of the hood without folding them (ensure that the tabs are completely hidden).



12. Fold the bumper section outward along the folding lines so that the center bulges outward. Then, make the ends a rounded shape.
13. Glue the tabs at each end to the upper section without creasing them (make the paper a rounded shape as you glue it).

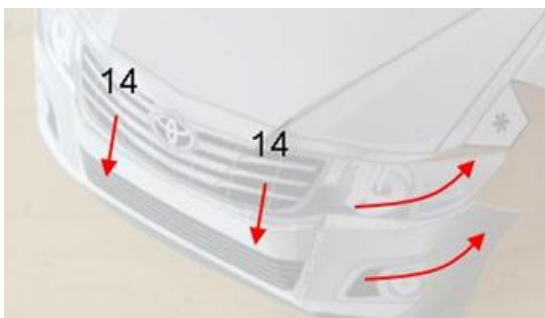

14. Glue the grill and the bumper together, then make this section a rounded shape at the ends.



15. Glue the tab to the side section (ensure that the dotted line is hidden). (Repeat the same process on the opposite side.)

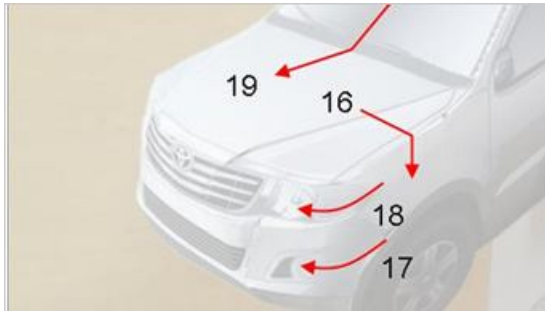

16. Glue the tabs on the side of the hood section to the side section of the body without folding them.  
 17. Glue the tab to the bumper section without folding it.  
 18. Glue the tab to the back side of the light without folding it.  
 (Repeat these processes on the opposite side.)  
 19. Fold the tabs outward and glue them to the hood.

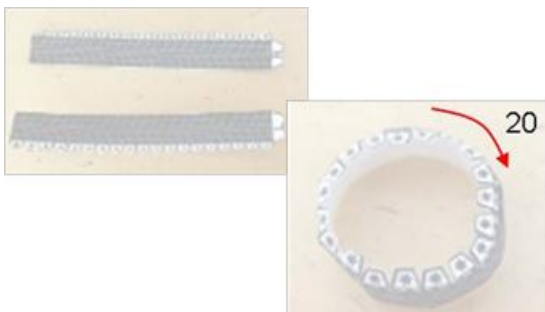

20. Make each tire tread into a circle and glue the ends together, then fold the tabs inward.  
 (Repeat the same process for all four tires.)

#### Tip for better results

Wrapping the tire treads around a cylindrical object such as a pen will give them a more rounded shape. This will help you to achieve a better finished product.



21. Glue the tire treads to the inside of the tire outers on the vehicle's main body.  
 (When gluing the tire treads to the body, be sure to check the L (left) and R (right) marks to confirm you are gluing them on the correct side of the car.)

## Completed

